

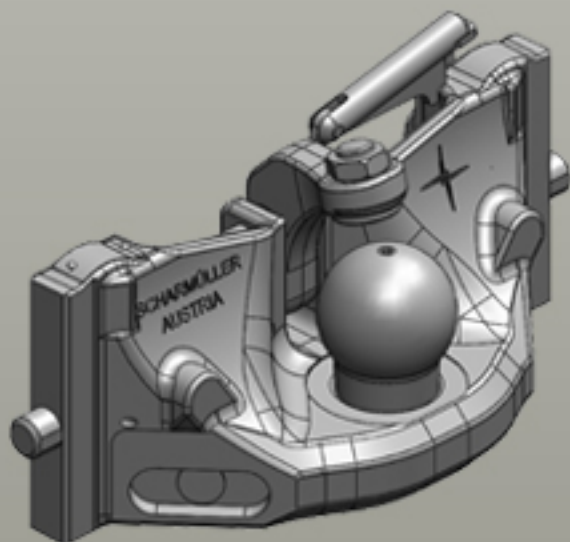









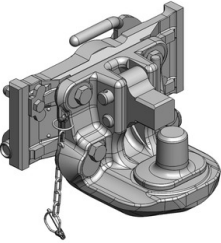

Inserts for Ladder Hitches

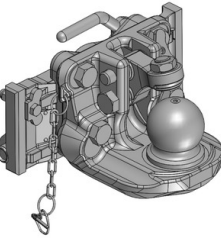
Assembly Dimension JSV-Scharmüller (325/25/26)

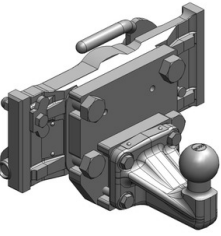

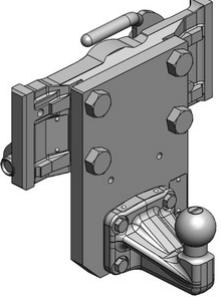
scharmüller 
ANHÄNGERKUPPLUNGEN

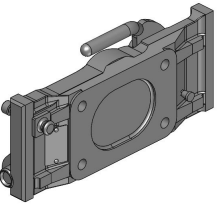
Inserts for Ladder Hitches

	<p>Art.Nr. 05.6325.10-A02 Inserts for Ladder Hitches Coupling Inserts Draw-Pin (Pitonfix) Assembly Dimension JSV-Scharmüller (325/25/26)</p> <p>Alternative color </p> <p>05.6325.10-A02 (Black)</p> <p>Technical Values*</p> <p>Thread: M16 Working Length (mm): 167 Adapter Plate Height (mm): 133 Locking: Draw Pin (Pitonfix) Manual Max. Permissible D-Value (kN): 83,9 Max. Permissible Vertical Load (kg): 2000 • Height Adjustable with Grabhandle</p>
	<p>Art.Nr. 05.6325.33-A02 Inserts for Ladder Hitches Coupling Inserts K80® Ball Coupling System Assembly Dimension JSV-Scharmüller (325/25/26)</p> <p>Alternative color </p> <p>05.6325.33-A02 (Black)</p> <p>Technical Values*</p> <p>Thread: M20 Working Length (mm): 177 Adapter Plate Height (mm): 133 Locking: K80® Manual Max. Permissible D-Value (kN): 83,9 Max. Permissible Vertical Load (kg): 2000 • Height Adjustable with Grabhandle</p>
	<p>Art.Nr. 05.7325.03-A02 Inserts for Ladder Hitches Coupling Inserts ISO 50 (Car) Assembly Dimension JSV-Scharmüller (325/25/26)</p> <p>Alternative color </p> <p>05.7325.03-A02 (Black)</p> <p>Technical Values*</p> <p>Thread: M20 Working Length (mm): 180 Adapter Plate Height (mm): 133 Max. Permissible D-Value (kN): 31 Max. Permissible Vertical Load (kg): 250 • Height Adjustable with Grabhandle</p>
	<p>Art.Nr. 05.7325.05-A02 Inserts for Ladder Hitches Coupling Inserts ISO 50 (Car) Assembly Dimension JSV-Scharmüller (325/25/26)</p> <p>Alternative color </p> <p>05.7325.05-A02 (Black)</p> <p>Technical Values*</p> <p>Thread: M20 Working Length (mm): 160 Adapter Plate Height (mm): 133 Max. Permissible D-Value (kN): 31 Max. Permissible Vertical Load (kg): 250 • Coupling-Point 10cm lower • Height Adjustable with Grabhandle</p>
	<p>Art.Nr. 05.7200.00-A02 Inserts for Ladder Hitches Adapter Plates Assembly Dimension JSV-Scharmüller (325/25/26)</p> <p>Alternative color </p> <p>05.7200.00-A02 (Black)</p> <p>Technical Values*</p> <p>Flange Hole Pattern (mm): 140x80 Thread: M16 Hole Pattern Holes: 4 Adapter Plate Height (mm): 133 Max. Permissible D-Value (kN): 83,9 Max. Permissible Vertical Load (kg): 2000 • Height Adjustable with Grabhandle</p>

Inserts for Ladder Hitches

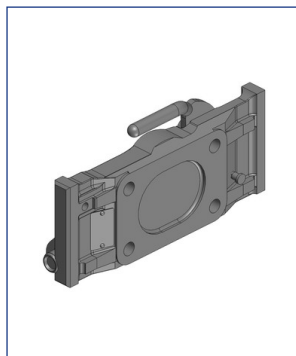

Art.Nr. 05.7200.20-A02 | Inserts for Ladder Hitches | Adapter Plates

Assembly Dimension JSV-Scharmüller (325/25/26)

Alternative color

05.7200.20-A02 (Black)

Technical Values*

Flange Hole Pattern (mm): 140x80 | **Thread:** M20 | **Hole Pattern Holes:** 4 | **Adapter Plate Height (mm):** 133 |
Max. Permissible D-Value (kN): 83,9 | **Max. Permissible Vertical Load (kg):** 2000 | • Height Adjustable with Grabhandle

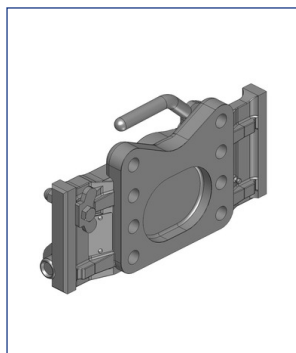

Art.Nr. 05.7325.33-A02 | Inserts for Ladder Hitches | Adapter Plates

Assembly Dimension JSV-Scharmüller (325/25/26)

Alternative color

05.7325.33-A02 (Black)

Technical Values*

Flange Hole Pattern (mm): 140x80 | **Thread:** M20 | **Hole Pattern Holes:** 8 | **Adapter Plate Height (mm):** 133 |
Max. Permissible D-Value (kN): 83,9 | **Max. Permissible Vertical Load (kg):** 2000 | • Height Adjustable with Grabhandle