

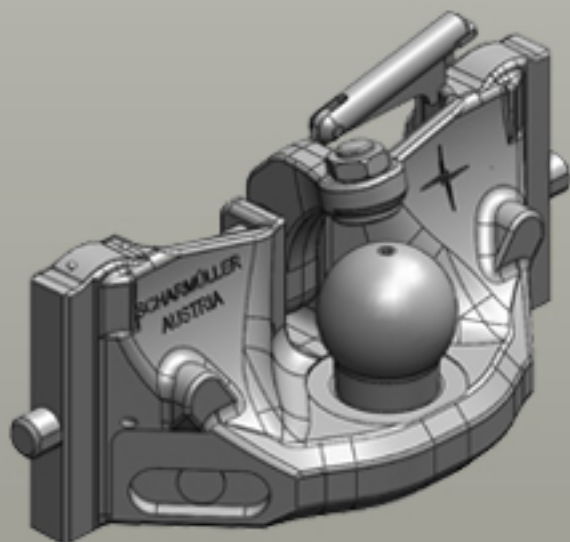







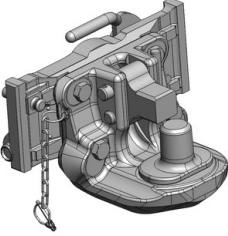

# Inserts for Ladder Hitches

Assembly Dimension JSV-Scharmüller (295/25/26)

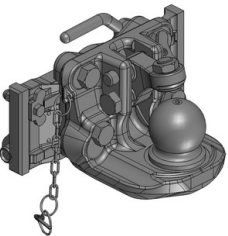

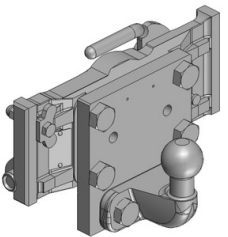
**scharmüller**   
ANHÄNGERKUPPLUNGEN

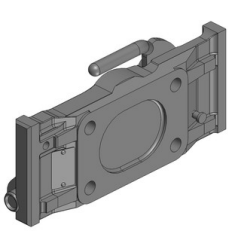
## Inserts for Ladder Hitches

	<p><b>Art.Nr. 05.6295.10-A02   Inserts for Ladder Hitches   Coupling Inserts</b>  Draw-Pin (Pitonfix)   Assembly Dimension JSV-Scharmüller (295/25/26)</p> <p><b>Alternative color</b> </p> <p>05.6295.10-A02 (Black )</p> <p><b>Technical Values*</b></p> <p><b>Thread:</b> M16   <b>Working Length (mm):</b> 166   <b>Adapter Plate Height (mm):</b> 133   <b>Locking:</b> Draw Pin (Pitonfix) Manual   <b>Max. Permissible D-Value (kN):</b> 83,9   <b>Max. Permissible Vertical Load (kg):</b> 2000   • Height Adjustable with Grabhandle</p>
	<p><b>Art.Nr. 05.6295.30-A02   Inserts for Ladder Hitches   Coupling Inserts</b>  K80® Ball Coupling System   Assembly Dimension JSV-Scharmüller (295/25/26)</p> <p><b>Alternative color</b> </p> <p>05.6295.30-A02 (Black )</p> <p><b>Technical Values*</b></p> <p><b>Thread:</b> M16   <b>Working Length (mm):</b> 166   <b>Adapter Plate Height (mm):</b> 133   <b>Locking:</b> K80® Manual   <b>Max. Permissible D-Value (kN):</b> 83,9   <b>Max. Permissible Vertical Load (kg):</b> 2000   • Height Adjustable with Grabhandle</p>
	<p><b>Art.Nr. 05.7295.00-A02   Inserts for Ladder Hitches   Coupling Inserts</b>  ISO 50 (Car)   Assembly Dimension JSV-Scharmüller (295/25/26)</p> <p><b>Alternative color</b> </p> <p>05.7295.00-A02 (Black )</p> <p><b>Technical Values*</b></p> <p><b>Thread:</b> M16   <b>Working Length (mm):</b> 127   <b>Adapter Plate Height (mm):</b> 133   <b>Max. Permissible D-Value (kN):</b> 17   <b>Max. Permissible Vertical Load (kg):</b> 200   • Height Adjustable with Grabhandle</p>
	<p><b>Art.Nr. 05.7300.00-A02   Inserts for Ladder Hitches   Adapter Plates</b>  Assembly Dimension JSV-Scharmüller (295/25/26)</p> <p><b>Alternative color</b> </p> <p>05.7300.00-A02 (Black )</p> <p><b>Technical Values*</b></p> <p><b>Flange Hole Pattern (mm):</b> 140x80   <b>Thread:</b> M16   <b>Hole Pattern Holes:</b> 4   <b>Adapter Plate Height (mm):</b> 133   <b>Max. Permissible D-Value (kN):</b> 83,9   <b>Max. Permissible Vertical Load (kg):</b> 2000   • Height Adjustable with Grabhandle</p>