

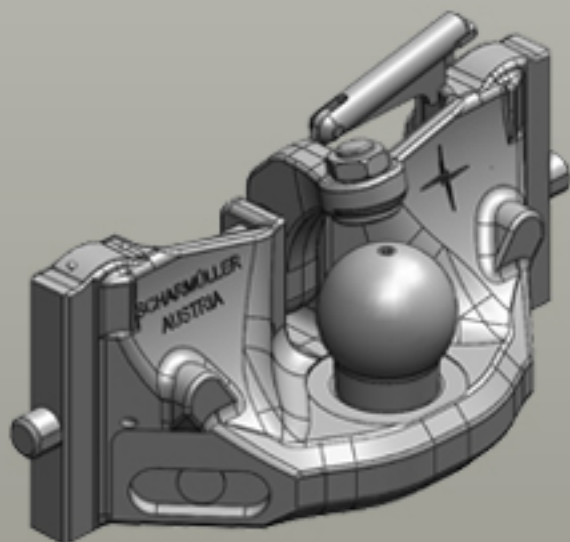









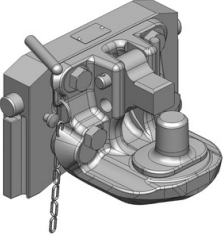

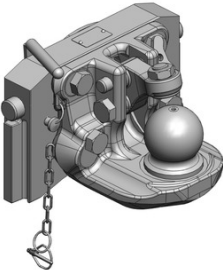
Inserts for Ladder Hitches

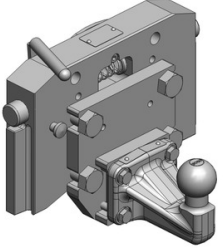
Assembly Dimension Saueremann (320/30/20)

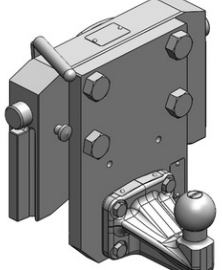

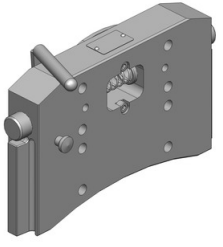
Inserts for Ladder Hitches

	<p>Art.Nr. 03.6320.25-A02 Inserts for Ladder Hitches Coupling Inserts Draw-Pin (Pitonfix) Assembly Dimension Sauermann (320/30/20)</p> <p>Alternative color </p> <p>03.6320.25-A02 (Black)</p> <p>Technical Values*</p> <p>Thread: M20 Working Length (mm): 155 Adapter Plate Height (mm): 190 Locking: Draw Pin (Pitonfix) Manual Max. Permissible D-Value (kN): 89,3 Max. Permissible Vertical Load (kg): 3000 • Height Adjustable with Grabhandle</p>
	<p>Art.Nr. 03.6320.46-A02 Inserts for Ladder Hitches Coupling Inserts K80® Ball Coupling System Assembly Dimension Sauermann (320/30/20)</p> <p>Alternative color </p> <p>03.6320.46-A02 (Black)</p> <p>Technical Values*</p> <p>Thread: M20 Working Length (mm): 155 Adapter Plate Height (mm): 190 Locking: K80® Manual Max. Permissible D-Value (kN): 89,3 Max. Permissible Vertical Load (kg): 3000 • Height Adjustable with Grabhandle</p>
	<p>Art.Nr. 03.7320.04-A02 Inserts for Ladder Hitches Coupling Inserts ISO 50 (Car) Assembly Dimension Sauermann (320/30/20)</p> <p>Alternative color </p> <p>03.7320.04-A02 (Black)</p> <p>Technical Values*</p> <p>Thread: M20 Working Length (mm): 168 Adapter Plate Height (mm): 190 Max. Permissible D-Value (kN): 31 Max. Permissible Vertical Load (kg): 250 • Height Adjustable with Grabhandle</p>
	<p>Art.Nr. 03.7320.08-A02 Inserts for Ladder Hitches Coupling Inserts ISO 50 (Car) Assembly Dimension Sauermann (320/30/20)</p> <p>Alternative color </p> <p>03.7320.08-A02 (Black)</p> <p>Technical Values*</p> <p>Thread: M20 Working Length (mm): 147 Adapter Plate Height (mm): 190 Max. Permissible D-Value (kN): 31 Max. Permissible Vertical Load (kg): 250 • Coupling-Point 5cm lower • Height Adjustable with Grabhandle</p>
	<p>Art.Nr. 03.7320.56-A02 Inserts for Ladder Hitches Adapter Plates Assembly Dimension Sauermann (320/30/20)</p> <p>Alternative color </p> <p>03.7320.56-A02 (Black)</p> <p>Technical Values*</p> <p>Flange Hole Pattern (mm): 140x80 Thread: M16 Hole Pattern Holes: 8 Adapter Plate Height (mm): 190 Max. Permissible D-Value (kN): 89,3 Max. Permissible Vertical Load (kg): 2000 • Height Adjustable with Grabhandle</p>

Inserts for Ladder Hitches

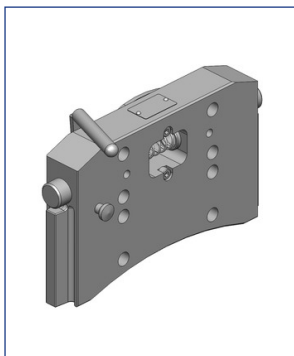

Art.Nr. 03.7320.57-A02 | Inserts for Ladder Hitches | Adapter Plates

Assembly Dimension Sauer mann (320/30/20)

Alternative color 

03.7320.57-A02 (Black)

Technical Values*

Flange Hole Pattern (mm): 140x80 | **Thread:** M20 | **Hole Pattern Holes:** 8 | **Adapter Plate Height (mm):** 190 |
Max. Permissible D-Value (kN): 89,3 | **Max. Permissible Vertical Load (kg):** 3000 | • Height Adjustable with Grabhandle