

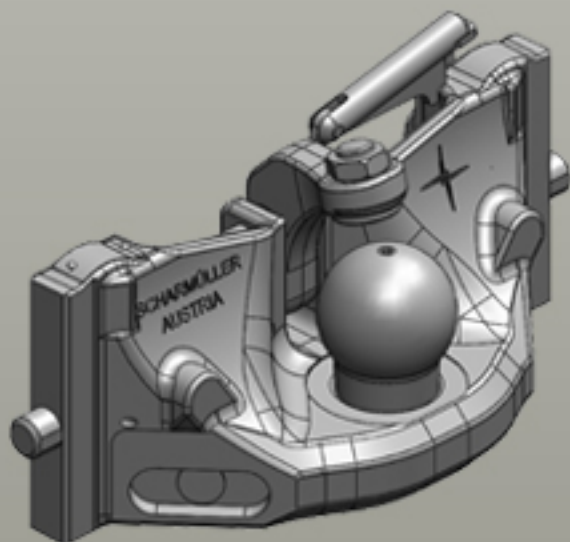









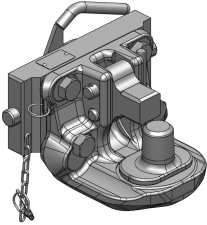

Inserts for Ladder Hitches

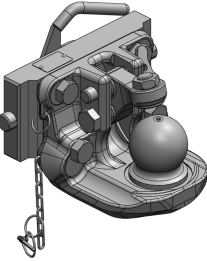
Assembly Dimension Scharmüller S32 (255/25/32)

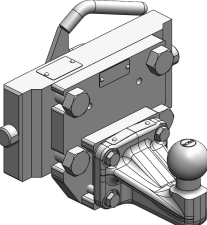

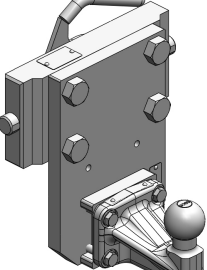
scharmüller 
ANHÄNGERKUPPLUNGEN

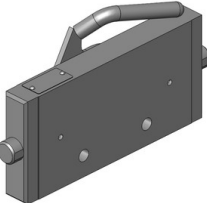
Inserts for Ladder Hitches

	<p>Art.Nr. 03.6255.15-A02 Inserts for Ladder Hitches Coupling Inserts Draw-Pin (Pitonfix) Assembly Dimension Scharmüller S32 (255/25/32)</p> <p>Alternative color </p> <p>03.6255.15-A02 (Black) 03.6255.15-A23 (Kioti-Grey)</p> <p>Technical Values*</p> <p>Thread: M20 Working Length (mm): 155 Adapter Plate Height (mm): 120 Locking: Draw Pin (Pitonfix) Manual Max. Permissible D-Value (kN): 83,9 Max. Permissible Vertical Load (kg): 2000 • Height Adjustable with Grabhandle</p>
	<p>Art.Nr. 03.6255.35-A02 Inserts for Ladder Hitches Coupling Inserts K80® Ball Coupling System Assembly Dimension Scharmüller S32 (255/25/32)</p> <p>Alternative color </p> <p>03.6255.35-A02 (Black) 03.6255.35-A17 (JD-Green)</p> <p>Technical Values*</p> <p>Thread: M20 Working Length (mm): 155 Adapter Plate Height (mm): 120 Locking: K80® Manual Max. Permissible D-Value (kN): 83,9 Max. Permissible Vertical Load (kg): 2000 • Height Adjustable with Grabhandle</p>
	<p>Art.Nr. 03.7255.04-A02 Inserts for Ladder Hitches Coupling Inserts ISO 50 (Car) Assembly Dimension Scharmüller S32 (255/25/32)</p> <p>Alternative color </p> <p>03.7255.04-A02 (Black)</p> <p>Technical Values*</p> <p>Thread: M10 / M20 Working Length (mm): 167 Adapter Plate Height (mm): 120 Max. Permissible D-Value (kN): 31 Max. Permissible Vertical Load (kg): 250 • Height Adjustable with Grabhandle</p>
	<p>Art.Nr. 03.7255.05-A02 Inserts for Ladder Hitches Coupling Inserts ISO 50 (Car) Assembly Dimension Scharmüller S32 (255/25/32)</p> <p>Alternative color </p> <p>03.7255.05-A02 (Black)</p> <p>Technical Values*</p> <p>Thread: M10 / M20 Working Length (mm): 167 Adapter Plate Height (mm): 120 Max. Permissible D-Value (kN): 31 Max. Permissible Vertical Load (kg): 250 • Coupling-Point 10cm lower • Height Adjustable with Grabhandle</p>
	<p>Art.Nr. 03.7255.10-A02 Inserts for Ladder Hitches Adapter Plates Assembly Dimension Scharmüller S32 (255/25/32)</p> <p>Alternative color </p> <p>03.7255.10-A02 (Black) 03.7255.10-A10 (Iseki-Grey) 03.7255.10-A12 (Same Blueblack) 03.7255.10-A16 (Kubota-Grey) 03.7255.10-A23 (Kioti-Grey)</p> <p>Technical Values*</p> <p>Thread: M16 Hole Pattern Holes: 2 Adapter Plate Height (mm): 120 Max. Permissible D-Value (kN): 25,5 Max. Permissible Vertical Load (kg): 1200 Hole Pattern/Hole Distance (mm): 90 • Height Adjustable with Grabhandle</p>

Inserts for Ladder Hitches

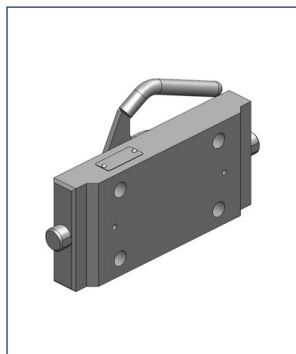

Art.Nr. 03.7255.35-A02 | Inserts for Ladder Hitches | Adapter Plates

Assembly Dimension Scharmüller S32 (255/25/32)

Alternative color

03.7255.35-A02 (Black) | 03.7255.35-A17 (JD-Green) | 03.7255.35-A23 (Kiotti-Grey)

Technical Values*

Flange Hole Pattern (mm): 140x80 | **Thread:** M20 | **Hole Pattern Holes:** 4 | **Adapter Plate Height (mm):** 120 |
Max. Permissible D-Value (kN): 83,9 | **Max. Permissible Vertical Load (kg):** 2000 | • Height Adjustable with Grabhandle